

DWG. No.: 29122

P/N	CAPACITY	A	B	C	D	E	F	G	H	I	J	K
5500A	2/3 CU. FT.	13 1/4	2 15/16	11 5/8	5	20 1/4	7 1/4	12 3/4	5	8 1/2	15 3/16	6 11/16
5500B	2 CU. FT.	18 1/4	2 7/32	11 5/8	6 1/2	25 7/32	7 1/4	12 3/4	8 1/4	8 1/2	14 9/16	6 1/16
5500C	5 CU. FT.	24 1/4	1 11/16	13 5/8	7 1/2	30 13/16	7 1/4	12 3/4	11 3/4	8 1/2	14 5/32	5 21/32
5500D	6 CU. FT.	30 1/4	2 33/64	16 5/8	10	38 1/2	8 1/2	15 5/16	7 1/2	19	24 21/32	5 21/32

NOTE: CHUTE TO BE SYMMETRICAL
NO TAPER ON 3-5 & 6-10 CU. FT.
HOPPER MODELS.

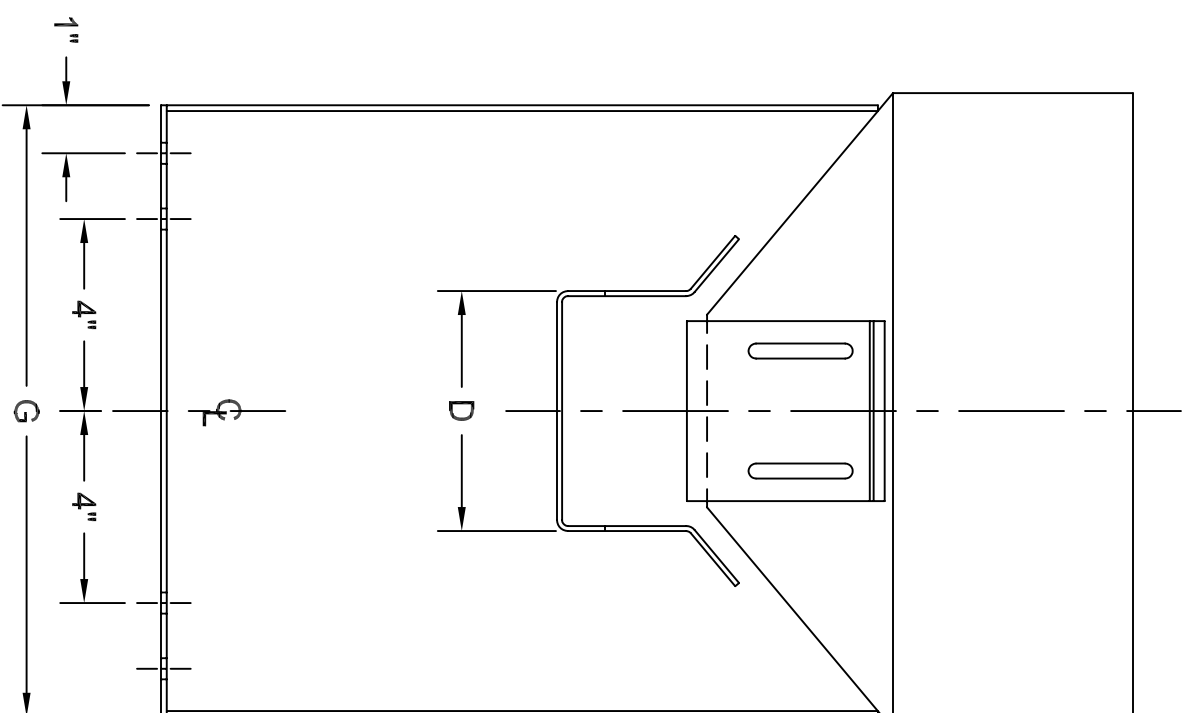
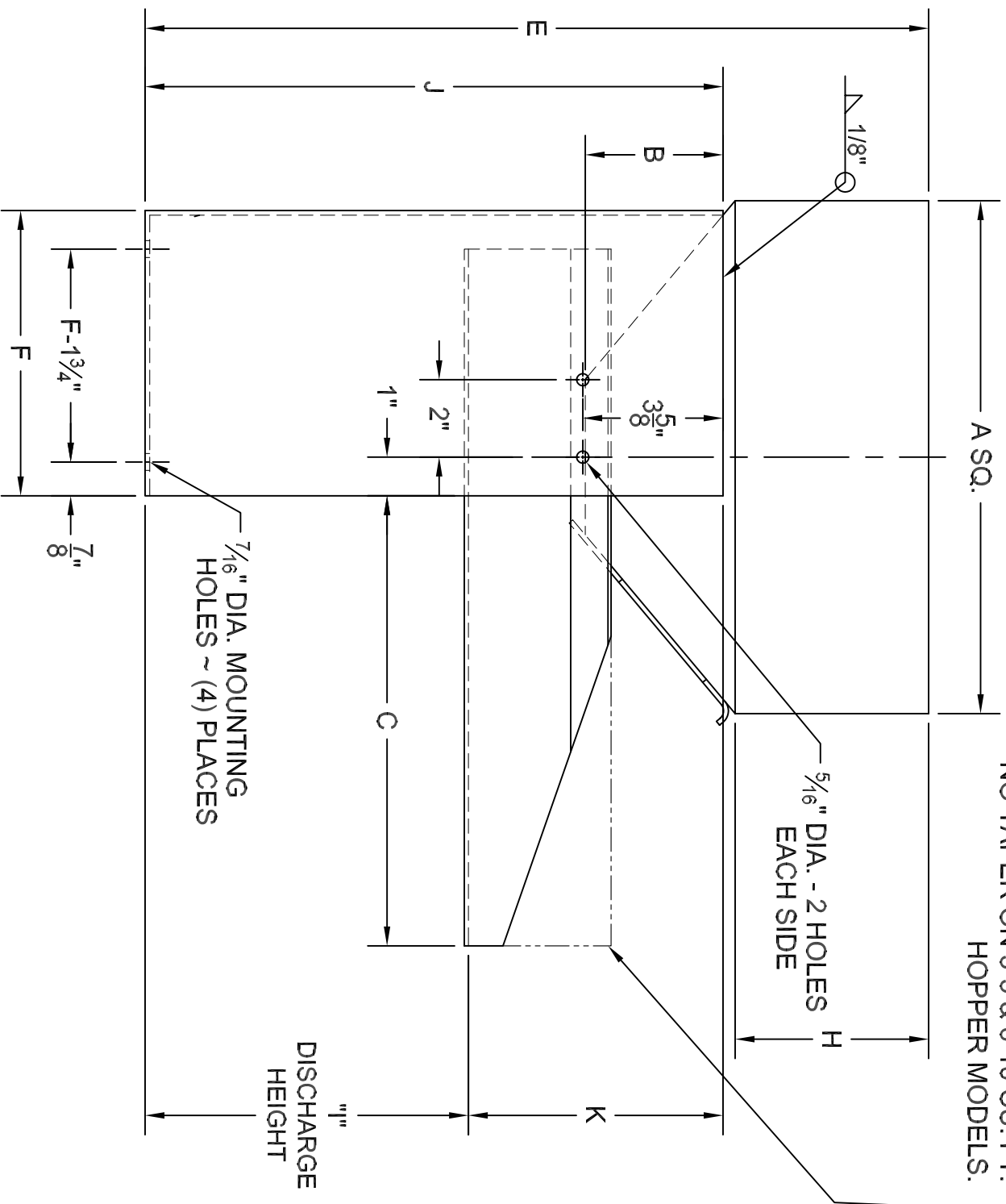

(L) (L) (L)

DRAWING TITLE: HOPPER DIMENSIONS

FOR: SERIES 5500 PAN FEEDER HOPPER

SCALE: NONE
DRAWN BY: JP
DATE: 9-27-02
APPROVED BY: TS
DATE: 9-27-02

AUTOMATION DEVICES, INC.

7050 WEST RIDGE ROAD FAIRVIEW, PA 16415-2099

PHONE: 814-474-5561 FAX 814-474-2131

www.autodev.com

LTR	REVISIONS	DATE	INIT
L	GENERAL REVISION PER KS	11-12-03	TLS
K	DIMENSION CHANGE	9-27-02	JP
J	ADDED WELD NOTE	5-1-00	JAP
I	REDRAWN IN CAD	6-8-99	JAP

TOLERANCE UNLESS OTHERWISE SPECIFIED
DECIMAL: .00 ±.015 .000 ±.005
FRACTIONAL: ±1/64 ANGLES: ±1/2°
-DO NOT SCALE DRAWING-

MATERIAL:

PART No.: 5500A-5500D

DWG. No.: 29122

DWG. No.: 29122